

Concepts



inside

► **IMAGINE**

Where you'll find more ideas than you could ever imagine

► **Remodeling?**

We've got the expert team

► **Late-Breaking News**

See page 4 to learn of our historic lakefront property in Highland Park

Here are two room settings from IMAGINE Your Home by Orren Pickell, our exciting new concept center in Northfield. (See more on page 2).

Introducing Tarns of the Moor

A tribute to the Scottish heritage of Bannockburn, Tarns of the Moor is an enchanting new community presented by Orren Pickell Designers & Builders. Surrounded by serene woods and tranquil ponds, "Tarns," a Scottish term for little lakes, offers ten magnificent estate home sites conveniently located on Telegraph Road, ½ mile south of Half Day Road (Route 22). This extraordinary property, which will include charming bridges and water features, is one of the most significant to become available on the North Shore in years.

An exclusive new community that has all the charm and beauty of a country estate with the convenience, amenities and quality schools of the North Shore, Tarns is within walking distance to the highly-rated elementary school and close to Deerfield High School.

Ten heavily wooded estate sites designed to protect native trees and conservancy areas range from 2.2 to 3.7 acres and are each available from \$1.2 million. All homes will be designed and built entirely to the owner's specifications by the award-



The Scottish Manor will be our next Concept House at Tarns of the Moor in Bannockburn.



200 Tri-State International, Suite 200
Lincolnshire, IL 60069

Telephone: 847.572.5200
www.pickellbuilders.com

See **TARNS** page 4

IMAGINE

Your Home by Orren Pickell

Now you truly can IMAGINE yourself in a custom-designed, state-of-the-art kitchen, bath or entire home by Orren Pickell. An interactive concept and idea center, IMAGINE showcases ten diverse room settings, all featuring the latest in award-winning design and quality craftsmanship.

Located at 1799 Willow Road in Northfield at the corner of Happ and Willow (just west of the Edens expressway next to Starbucks), IMAGINE informs and inspires as you make your way from a contemporary Italian kitchen to a traditional family room or explore a luxurious zen spa bath, pocket library or vaulted wine cellar.

"What I like best about this space is that you can come in and get some great ideas and then modify them to fit your needs. Additionally, you have top-notch professionals and limitless resources at your fingertips," said Orren Pickell, founder and chief executive officer of his namesake firm.

From the travertine floor reminiscent of the Versailles Palace, to the limestone and onyx countertops, to the exclusive hand painted designs by Orren Pickell and the custom bar made of reclaimed wine barrels, every inch of IMAGINE features products and designs you can bring to your home remodeling or new construction projects.

Plasma screens and interactive computer stations are available throughout the spacious showroom and are updated with the newest materials and innovative ideas on a regular basis. Award-winning architects, kitchen and bath designers, and new construction and remodeling experts are also available for consultations at IMAGINE.

The new Orren Pickell Home Collection of furniture and accessories represents a distinctive and sophisticated take on the new classics. IMAGINE is the single resource for this stylish line that features the same integrity and artistry of our award-winning homes. CabinetWerks, a Pickell company, showcases beautiful furniture-quality custom cabinetry and Wood-Mode lines at IMAGINE, which is also the only Midwest showroom to feature Aster Cucine, Italy's premier contemporary kitchen collection.

IMAGINE is open seven days a week: Monday through Saturday 10 am- 6 pm, Sunday 11 am- 5 pm or by private appointment. For additional information, call 847.572.5252 or visit www.ImagineByPickell.com.



IMAGINE's pocket library is a favorite among visitors.

SAVE THE DATES

ELECTRONIC GIFTS FOR THE HOME

Saturday December 2, 2006
11 am - 1 pm

Explore the latest hi-tech innovations for your home.

ROMANCING YOUR HOME

Thursday, February 8, 2007
5 pm - 7 pm

Home maintenance experts will present special tips on caring for your home. Our remodeling pros will also be on hand.



The Family Workshop

Handsome Country French Home Available



In Wilmette, an enchanting four-bedroom cedar house at 913 Forest for \$2,295,000



In Winnetka, a stately brick residence at 371 Walnut for \$2,195,000



This incomparable Orren Pickell home at 2044 Balmoral Avenue in Glenview is now available for \$1,895,000.

This fabulous new Orren Pickell home in Glenview's sought-after Glen Oak Acres features a stunning two-story foyer with charming views through the expansive family room and out to the beautifully landscaped yard, dining room with butler's pantry, gourmet CabinetWerks kitchen and bright breakfast room. The second floor offers an elegant master suite and three additional suites plus spacious bonus room/fifth bedroom. The finished basement adds a lower-level family room, exercise room, sixth bedroom, full bath and more! This exceptional home has a three-car attached garage and is situated on more than half an acre. For more information or an appointment, please call 847.572.5200.

Pickell Homes Grab the Gold

This South Shore residence in Lake Geneva captured a Gold Key Award for architectural design in the custom home category at the Homebuilders Association of Greater Chicago's 2006 Key Awards. A grand revision of the traditional country estate, this home is made for entertaining! The gorgeous kitchen serves not only as the planning center for fabulous meals, but also as the family hub where there is room for everyone to gather.

The Key Awards are considered one of the most prestigious annual award events in the country recognizing exceptional work in the home building industry. "To be acknowledged by fellow architects and builders is especially rewarding," said Orren Pickell Designers & Builders President Tony Perry. "We are honored to be singled out in this competition with so many outstanding projects entered."

In total, Orren Pickell earned four Gold Key Awards for outstanding architectural design in the custom home categories; four Silver Key Awards for outstanding design in the custom home and remodel/conversion categories; and a Bronze Key Award for outstanding design in a remodel/conversion.



This expansive custom home in Lake Geneva, Wisconsin took home the Gold!

Expert Remodeling and Renovation

Focusing on design excellence, quality, timeliness and convenience the Orren Pickell Remodeling Group builds lasting relationships with clients. We dedicate the same superior level of service and initiative that our clients have come to expect in every project regardless of size and scope.

In addition to our unwavering commitment to quality, we reduce our in-home time to an absolute minimum, guaranteeing excellence with on time and on budget completion.

Respectful of the heritage and aesthetics of traditional homes, our award-winning Remodeling Group has vast experience in the discerning restoration of older houses while updating these homes with the latest conveniences.

Our reputation is based on innovative designs and meticulous craftsmen working with the finest materials. We truly believe that a renovation or addition to your home can be a rewarding, positive experience, and we ensure that everyone on our team is prompt, polite and focused on the client's needs.

Our size, reputation and depth of experience affords us priority with the finest subcontractors and top suppliers allowing us to offer the widest selection of in-house resources and the greatest efficiency whether the project is a kitchen, bath, great room or total renovation.

For further information or a consultation about your remodeling needs, call 847.572.5200.

Below: A Silver Key went to this project by the Orren Pickell Remodeling Group.



Our Staff

EXECUTIVE
Orren Pickell, CEO
Anthony F. Perry, President
Michele Rath-Peterson, Executive Asst.

SPECIAL PROJECTS
Tina Pickell

LEGAL & HUMAN RESOURCES
Bart Kempff, Director of Development/
General Counsel
Sandy Berndt, HR Director
Ellen Groh, Paralegal
Jillian Burris, Receptionist

FINANCE DEPARTMENT
Rob Gadek, Chief Financial Officer
Darcy Rice, Controller
Melody Cervac, Senior Staff Accountant
Casey Reyes, Senior Project Analyst
Kevin Southwick, Network Administrator
Vic Alvarez, Programmer
Stephanie Helton-Rylatt, Accounts Payable
Kelly Shea, Accounts Receivable
Jennifer Graves, Payroll
Kathy Rohr, Job Cost Accountant
Dan Hernandez, Financial Analyst

SALES & MARKETING DIVISION
Todd Wilkins, Vice President of
Sales & Marketing
Patricia Wexler, Marketing Manager
Christine Kusher, Sales Associate
Kristen Kass, Sales Associate
Laura Harris, Sales Associate
Ron Smith, Sales Associates
Susan Schreiber, Sales Associate

IMAGINE SHOWROOM
Cathy Schager, Co-Showroom Manager
Tom Hackett, Co-Showroom Manager

PROJECT ESTIMATOR
Heath Siebert, Chief Estimator

PURCHASING DEPARTMENT
Kevin O'Sullivan, Purchasing Manager
Shannon Lassiter, Purchasing Assistant
Dominykas Giedraitis,
Construction Buyer/Coordinator
Henry Krupa,
Construction Buyer/Coordinator
Lowell Zarzuela,
Construction Buyer/Coordinator
Ron Zarzuela,
Construction Buyer/Coordinator
Scott Davis,
Construction Buyer/Coordinator

DESIGN GROUP
Kent DeReus, AIA, Managing Principal
John Anstadt, AIA, Managing Principal
Mark Benner, Principal
Beth Lindahl, Associate Principal
Brian Ries, Associate Principal
Jason DeBaker, Associate Principal
Jeff Eichhorn, Associate Principal
Len Eckhoff, Associate Principal
Jean Gonzales, Project Designer
Lisa Foster, Project Designer
Steve Schmitt, Project Designer
Kathy Miller, Selections Coordinator
Sondra Latiolais, Selections Coordinator
Sue Schroeder, Selections Coordinator
Tracy Konrath, Selections coordinator
Bobbi Luehrsen, Permit Coordinator

CABINETWERKS DESIGN STUDIO
Dave Heigl CKD, Vice President, Director of
CabinetWerks Design Studio
June Happ, Designer
Rick Banter, Designer
Anna Lokaj-Mackiewicz, Design Assistant
Elizabeth Pagels, Design Assistant
Emily Aikins, Design Assistant
Jason Ward, Design Assistant
Jodi Staples, Design Assistant
Katie Downie, Design Assistant
Michele Parsons, Design Assistant
Stephanie Lee, Design Assistant
Bill Parks, Project Superintendent
Pat Schwager, Installer
Terry Anderson, Installer
Mike Whalen, Showroom Manager

CARPENTRY DIVISION
Kurt Savageau,
Trim Carpentry Superintendent
Jim Wood,
Rough Carpentry Superintendent

REMODELING GROUP
Lisa Pickell, Remodel Manager
Rocky Rowe, Sales Associate
Tom Koutny, Sales Associate
Al Tinnon, Client Care Liaison
Tracie Peck, Client Care Liaison

HOME MAINTENANCE SERVICE DEPARTMENT
Warren Schwartz, Manager
Jenn Koeune, Maintenance Assistant
Jennifer Rifkin, Maintenance Assistant
Mitch Roper, Lead Technician
Carl Kraemer, Technician
Carlos Rodriguez, Technician
Jimmy Weinberg, Technician
Matt Koeune, Technician
Mike Loyd, Technician
Paul Brown, Technician
Skip Schallert, Technician
Terry Vincent, Painter

CONSTRUCTION SUPERINTENDENTS
Randy Richter, GM of Construction for IL
Scott Campbell, MI Regional Manager
Kevin Batz, WI Division, General Manager
Bob Martineau, Superintendent
Carl Waschow, Superintendent
Erik Hauser, Superintendent
Jack Ferguson, Superintendent
Jason McCall, Superintendent
Jim Arquilla, Superintendent
Kevin O'Leary, Superintendent
Mark Potesta, Superintendent
Phil Rizzo, Superintendent
Vince Janowski, Superintendent

© 2006. All rights reserved.

Concepts is published by
Orren Pickell Designers & Builders,
200 Tri-State International, Suite 200,
Lincolnshire, IL 60069.

Designer: Allegro Design Inc.
Agency: Winger & Associates, Ltd.
Photographer: Linda Oyama Bryan

For more information, visit our website at
www.pickellbuilders.com or call us at
847-572-5200. Our fax number is
847-572-5299. Our email address is
info@pickellbuilders.com



Tarns (from page 1)

winning Pickell team known for creating luxury homes to accommodate individual needs and lifestyles. Two lots have already been reserved.

Tarns of the Moor provides easy access to expressways and Metra train service, fine restaurants and shopping and will continue the "garden suburb" philosophy of Bannockburn.

A graceful roadway, walking paths connected to the adjacent village park and lush landscaping will compliment the natural terrain. A land berm and landscape buffer will finish the storybook property.

For more detailed information about Tarns of the Moor, please call 847.572.5200 or visit www.pickellbuilders.com

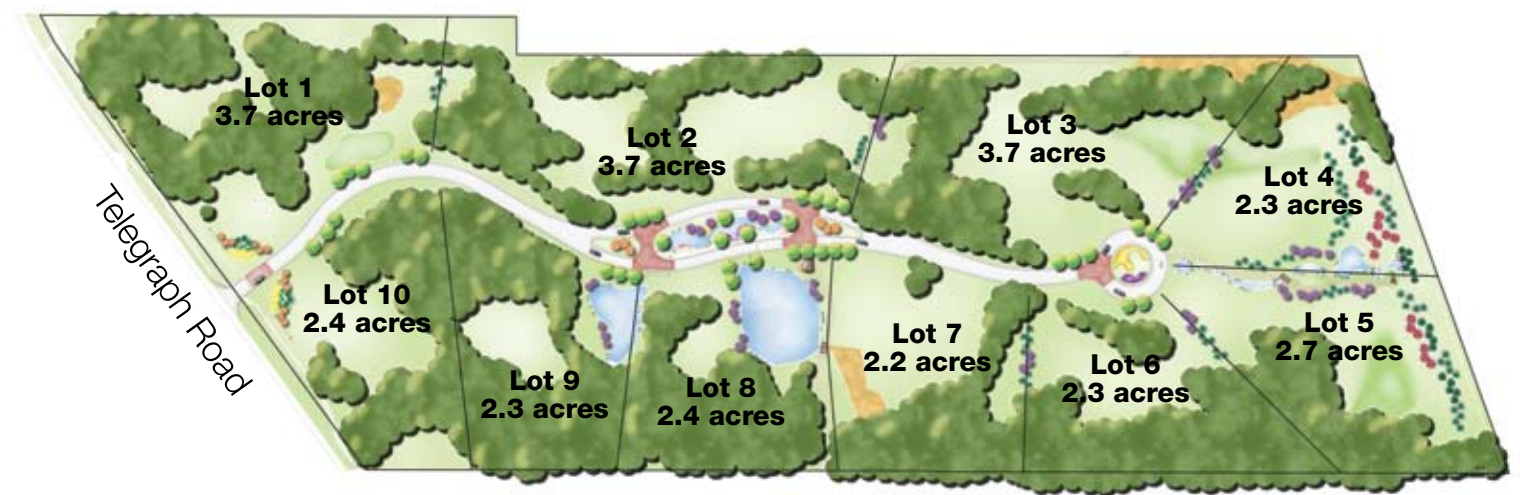

Winter Tips

Prepare your home for winter and stay warm inside with the following tips. Our Maintenance Department is always available to help with one-time projects or year-round maintenance duties. For more information on how we can help maintain your home, call 847.572.5200.

- Schedule furnace and chimney service and cleaning
- Check and repair any gaps in caulking, fill damaged wood or repair masonry siding
- Add weather stripping seals around doors
- Clear gutters and downspouts of debris
- Check ceiling insulation to prevent roof ice dams

Late News!

At press time, Orren Pickell Designers & Builders announced the purchase of 17 acres of premier lakefront property in Highland Park. Known as the A.G. Becker Estate, Pickell is collaborating with various state and local organizations regarding the preservation of key architectural structures by Howard Van Doren Shaw and landscape elements by noted American landscape architect Jens Jensen.

The Pickell team is committed to act as steward of the land restoring both the historic landscape that includes the magnificent Jensen meadow as well as the Van Doren Shaw residence and coach house. For additional information, please contact Ron Smith at 847.572.5200.

Warm Wishes for a Bright and Happy Holiday Season

At Orren Pickell Designers & Builders we are privileged to do what we love; to create the homes of our clients' dreams, to design and build inviting and comfortable surroundings where families grow and thrive.

And perhaps the best part of what we do is getting to know our clients and creating homes that reflect their individual styles and specific needs. As we look ahead to the activities that fill Thanksgiving celebrations and the busy holiday season, we hope this special time of the year finds you and your family healthy and comfortable in the home of your dreams.

From our family to yours, HAPPY HOLIDAYS!



Tony Perry
President



Orren Pickell
Chief Executive Officer